

# LEAN-TO

FOR STOREFRONT CART RETURNS



Brasco's Lean-To cart corrals are designed for retailers with cart return locations at the front or side of stores. These corrals are engineered to meet local wind and snow load capacities, are made from aluminum and have a life expectancy of 20+ years.

All roofs arrive pre-assembled, reducing installation time and cost. Easily tailor this corral to meet any store brand by choosing the powder coat color of preference for the frame and select from structured polycarbonate, acrylic or standing seam aluminum for the roof glazing. For locations with inclement weather, this corral style offers optional wall glazing panels for more protection.

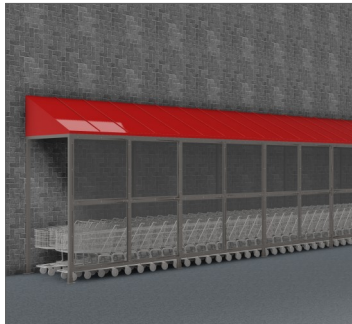
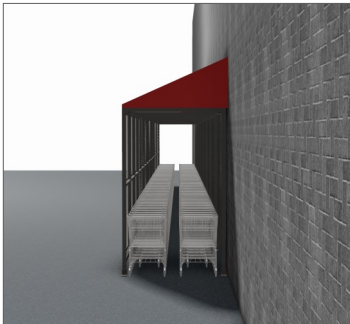

## Standard Specifications

### WIDTH

3', 5', 7 1/2'

### LENGTH

14', 29'

### HEIGHT

9'

### FRAME

2-1/2" Square Aluminum Tube

### CONFIGURATION

Single Length  
Double Length

### FINISH

Mill  
Powder Coat Finish  
Clear or Dark Bronze Anodized Finish

### WALL GLAZING

Structured Polycarbonate  
Tempered Glass  
Acrylic

### CART CONTROL

Mill Aluminum Rollback Straps  
Mill Aluminum Bump Rails

### ANCHORING

Surface Mounted with Asphalt or  
Concrete Anchors

### POPULAR ADD ONS

Aluminum Banner with Vinyl Decal  
Column-mounted Trash Receptacle  
Custom Color Match  
Center Cart Divider  
Decorative Grillwork (Diamond, Square)